

Notable /

- ◆ To use the WISO with your Android™ device, make sure that the software version of your Android™ 4.4 or later and that your Android™ device supports the Bluetooth® 4.0 low energy standard. Also, remember that you need an active Internet connection for services.
- ◆ To use the WISO with your iOS device, make sure that the software version of your iOS 7 or later and that your iOS device supports the Bluetooth® 4.0 low energy standard. Also, remember that you need an active Internet connection for services.
- ◆ Google+, Twitter, Facebook, Yahoo! Japan, or mixi account is required for WISO APP.
- ◆ Extended SMS service is for emergency only. WISO reserves the right to suspend Extended SMS service if inappropriate usage is found.
- ◆ 10 free SMS will be credited to your account once the account is activated.
- ◆ SMS cannot be sent to Emergency contacts on international roaming.
- ◆ DO NOT SWIPE AWAY WISO APP on iPhone, otherwise emergency actions will not be activated.
- ◆ Please re-launch the app after you turn off your iPhone or reboot it.
- ◆ Emergency phone call feature is only for Android. It is not available in iOS platform due to its native restriction.
- ◆ WISO's location service depends heavily on the environment and user settings. It is required to enable Location service on your phone, and the GPS signal is strongest under the clear sky.
- ◆ WISO uses Bluetooth® 4.0 technology and has a range of 5-6 meters. WISO must be in range and connected in order to operate.



Quick
Start
Guide

www.theWISO.com
www.idolmemory.com



WISO Safety Notification Alarm

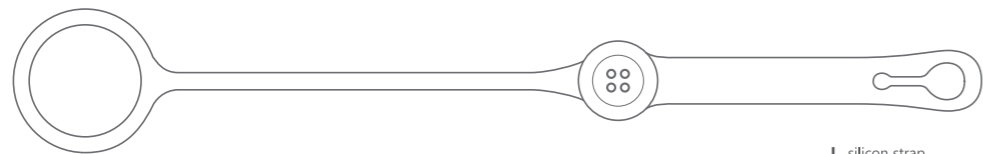

| silicon strap



WISO

WISO
(FDA-compliant PC)



| silicon mouth cover

Hardware overview

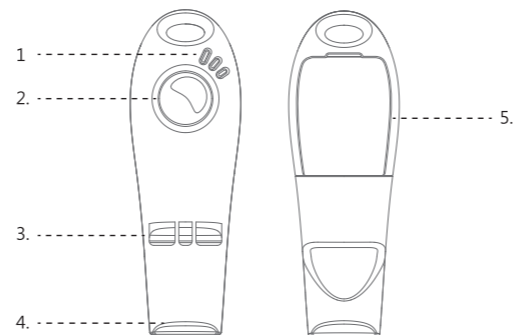

1. Notification LED

- ◆ Connected with smartphone: Blue (blink once every 60 seconds)
- ◆ Disconnected with smartphone: Red (blink twice every 5 seconds)
- ◆ Blowing or pressing emergency button: Red (steady for 10 seconds)
- ◆ Low power: Red (blink once every 10 seconds)

2. Emergency button

3. Chamber

4. Mouth

5. Battery door

Installing battery

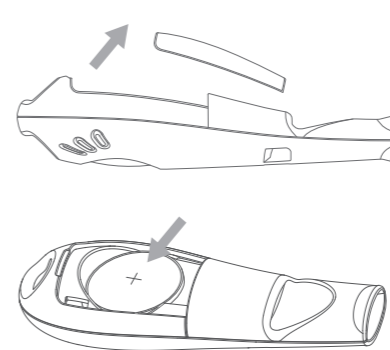

1. Remove your WISO from its packaging and open the battery door.

2. Insert the provided battery (CR 2032) into the back of the unit, with the "+" sign facing up. The battery will rest in the center of the compartment.

3. Once the battery is in place, close the battery door.

4. Download the WISO APP and get started with WISO APP setup.

Attaching accessory

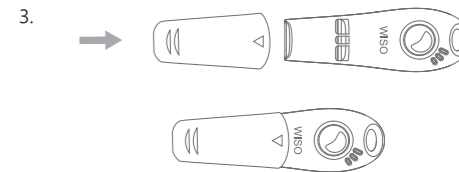
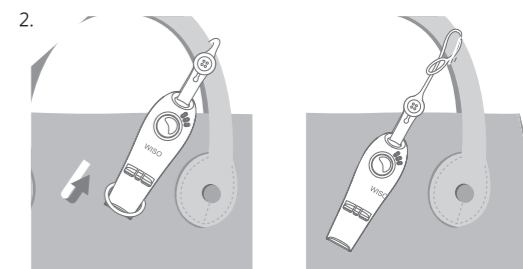
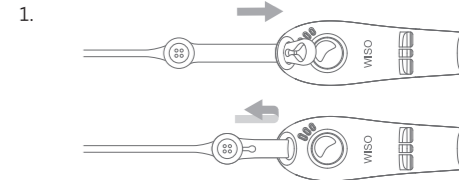

Use the cover to protect the WISO mouth.